

Prepared for -
 Custom Home Builder/Remodeler
 Northeast U.S.

ELECTRICAL PLAN - L2

Prepared by -
 Before The Architect
 Cumming, GA
 December 11, 2003
 SHEET 14 of 17

ELECTRICAL PLAN NOTES:

- FC LMR shall be applied selectively including the following: a) non-dimmer control applications; b) low-cost dimmer control applications; c) under cabinets (note that cabinet skirting or other modification to under-cabinets shall be required as necessary to conceal LMR from line of sight); d) cove, or valance-concealed, or tray, LMR applications; e) non-task applications.
- FC LMR loads shall be calculated based on high peak currents, conduit & CDRs sized and devices selected accordingly.
- GFCI DTL or CRC on the INT shall apply to a WL DTL BEL on openable WDW or w/in 3' on the HDR to an EXT DR.
- LMR loads shall be networked on LMR CRCs and non-LMR loads shall be networked on non-LMR CRCs and these 2 types of load shall not be mixed on any CRC.
- Every CRC from a PB shall be made up of NLT 1 energized, or phased, or hot CDR, 1 EDM or neutral or grounded CDR, and 1 box or green-wire grounding CDR. A grounded CDR in a given CRC shall not be connected to any other CRC, including that grounded CDR shall not be connected whatsoever to a grounding CDR in a panelboard, subpanel, junction box, device, etc.
- Installed cable for LMR and RCPs shall be NLT 12AWG/CU and NLT THHN or EQV at 20A overcurrent protection.
- LMRs subject to physical damage shall be caged or similarly force-protected, FC LMRs subject to physical damage shall additionally be sheathed in clear plastic cylinders or EQV DA.
- CLG LMRs may be pendulus, flush, or recessed at owners' direction, UDN; recessed lights shall be rated NLT IC/AT.
- INT exhaust fans shall run to EXT only.
- Air conduit shall be smooth INTL w/ each joint sealed by high-quality metal foil tape.
- Kitchenette U RCP DTL CRCs shall be NLT 2 and if more than 2 then shall be distributed so as to alternate CRCs.
- Devices shall be commercial grade or better; duplex RCPs shall be NGT 8/20A CRC.
- A smoke detector a.) shall be applied in each sleeping room; and b.) shall be applied outside each sleeping room; and c.) shall be connected to each other such that when one or more alarm, all alarm throughout the entire house, including EXG and addition per code.
- A CLG fan branch CRC shall include both motor and LMR controls DA, i.e., each CLG fan CRC shall contain 2 hot CDRs, 1 grounded CDR, and 1 grounding CDR. INTL BET WL, DTL and CLG DTL; an electric heater may be either 120V/SP or 240V/2P and shall be dedicated.
- Arc Fault CRC Interrupters shall be applied to every 120V CRC w/ DTL in designated spaces w/o regard to that CRC's application elsewhere.

KEY TO ABBREVIATIONS:

ABV = ABoVe
 APX = APProXimately
 BEL = BELow
 BET = BETween
 CDR = (electrical) Conductor
 CLG = CeLLING
 CDM = Common
 CDNT = CDNTinuous
 CRC = (electrical) CIRCUIT

CU = copper
 DIM = DIMension
 DR = DoOR
 E. = East
 EQV = EQuiValent
 EXG = EXistinG
 EXT EXTERior
 FC = FluoresCent
 GFCI = Ground Fault CRC
 Interrupter
 HDR = HDRizontal

HR = Home Run
 INT = INTerior
 LMR = Luminaire
 MIN = MINimum
 MTL = MeTL
 N. = North
 NGT = Not Greater Than
 NLT = Not Less Than
 DA = OverAll
 DTL = OutLet
 PB = PanelBoard

RCP = (electrical) Receptacle
 RM = Room
 S. = South
 TYP = TYPical
 U = Utility
 UDN = UNless Dtherwise Noted
 W. = West
 WDW = Window
 WIC = Walk-In Closet
 WL = WaLL

LEGEND:

○ Peripherals: CL = Cable; SD = Smoke detector, CV = Central Vacuum; TP = Telephone (landline)

⊕ LMR, default= CLG-mounted, may be pendant, surface-mounted, or recessed
 ⊙ Exhaust fan, CLG-mounted (to EXT, 150 CFM MIN)

⊕ RCP, duplex, 120V/20A only; G=GFCI; boxed=weatherproofed
 ⚡ Switch, default = SP
 W/3=2-way

KEY TO SPACES:

5. WIC
 6. Bedroom
 8. CLD
 9. Hall
 10. Sitting Room
 11. Master Bedroom
 12. Master Bathroom

NOTE that thermostat and dedicated computer circuits to be determined by others

Note that DIMs are to roughed, WLS are 3/4" true.

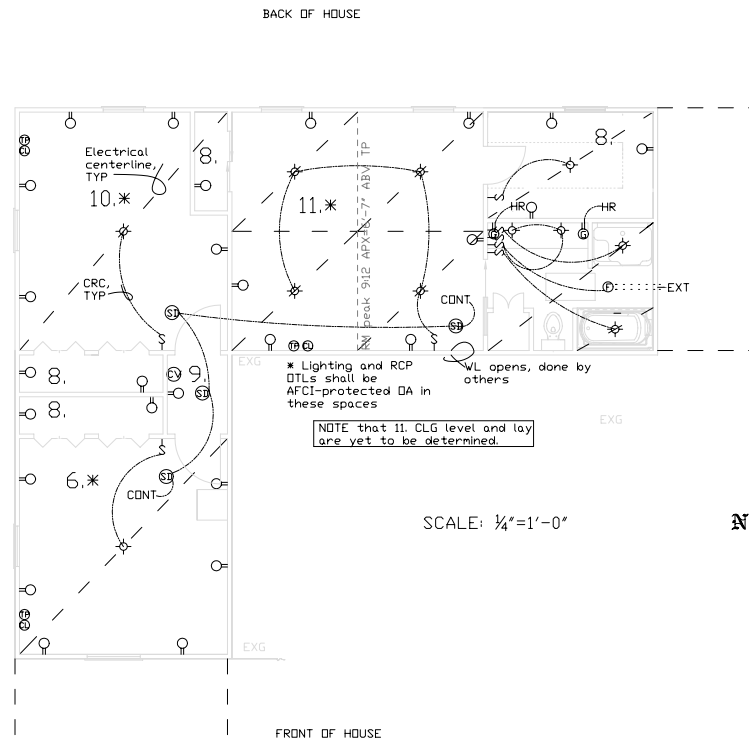

BIND LEFT

Copyright 2003 Before The Architect
<http://www.beforethearchitect.com>
 Errors & Omissions

DISCLAIMER: Before The Architect tried to do its best on this design plan based on knowledge, experience, statements, and instructions. However, others will provide on-site consulting, supervise and control construction, and no one on the planet can ever possibly know all the codes, requirements, means, materials, and other conditions involved in this project; therefore, there cannot be any warranty, express or implied, w/ respect to the content or use of this plan, including but not limited to any warranty of merchantability or fitness of construction, durability, function, safety, or hazards pre- or post-construction, or any liability for any errors or omissions due to incorrect information shown on this print. Use of this print is absolutely 100% at your own risk.