

Prepared for -
 Custom Home Builder/Remodeler
 Northeast U.S.

ELECTRICAL PLAN - L1

Prepared by -
 Before The Architect
 Cumming, GA
 December 1, 2003
 SHEET 13 of 17

ELECTRICAL PLAN NOTES:

- FC LMR shall be applied selectively including the following:
 - non-dimmer control applications;
 - low-cost dimmer control applications;
 - under cabinets (note that cabinet skirting or other modification to under-cabinets shall be required as necessary to conceal LMR from line of sight);
 - cove, or valance-concealed, or tray, LMR applications;
 - non-task applications.
- FC LMR loads shall be calculated based on high peak currents, conduit & CDRs sized and devices selected accordingly.
- GFCI DTL or CRC on the INT shall apply to a WL DTL BEL on an openable WDW or w/in 3' on the HR to an EXT DR.
- LMR loads shall be networked on LMR CRCs and non-LMR loads shall be networked on non-LMR CRCs and these 2 types of load shall not be mixed on any CRC.
- Every CRC from a PB shall be made up of NLT 1 energized, or phased, or not CDR, 1 EDM or neutral or grounded CDR, and 1 box or green-wire grounding CDR.
- A grounded CDR in a given CRC shall not be connected to any other CRC, including that grounded CDR shall not be connected whatsoever to a grounding CDR in a panelboard, subpanel, junction box, device, etc.
- Installed cable for LMR and RCPs shall be NLT 12AWG/CU and NLT THHN or EGV at 20A overcurrent protection.
- LMRs subject to physical damage shall be caged or similarly force-protected, FC LMRs subject to physical damage shall additionally be sheathed in clear plastic cylinders or EOV DA.
- CLG LMRs may be pendulous, flush, or recessed at owners' direction, UDN; recessed lights shall be rated NLT IC/AT.
- INT exhaust fans shall run to EXT only.
- Air conduit shall be smooth INTL w/ each joint sealed by high-quality metal foil tape.
- Kitchenette U RCP DTL CRCs shall be NLT 2 and if more than 2 then shall be distributed so as to alternate CRCs.
- Devices shall be commercial grade or better; duplex RCPs shall be NGT 8/20A CRC.
- A smoke detector a.) shall be applied in each sleeping room; and b.) shall be applied outside each sleeping room; and c.) shall be connected to each other such that when one or more alarm, all alarm throughout the entire house, including EXG and addition per code.
- A CLG fan branch CRC shall include both motor and LMR controls DA, i.e., each CLG fan CRC shall contain 2 hot CDRs, 1 grounded CDR, and 1 grounding CDR CDNT BET WL, DTL and CLG DTL; an electric heater may be either 120V/SP or 240V/2P and shall be dedicated.
- Arc Fault CRC Interrupters shall be applied to every 120V CRC w/ DTL in designated spaces w/o regard to that CRC's application elsewhere.

KEY TO ABBREVIATIONS:

- ABS = Absolute
 BEL = Below
 BET = Between
 C = Counter
 CDR = (electrical) Conductor
 CLG = Ceiling
 CLD = CLDset
 CDM = Common
 CDNT = CDNTinuous
 CRC = (electrical) CRcuit
- CU = copper
 DIM = DIMension
 DK = Deck
 DR = Door
 E = East
 EQV = EquiValent
 EXG = EXistIng
 EXT = EXTERior
 FC = FluoresCent
 G = Garage
 GFCI = Ground Fault CRc
 Interrupter
- HOR = HORIZontal
 HR = Home Run
 INT = INTERior
 K = Kitchen
 LMR = Luminaire
 LV = Low Voltage
 MIN = MINimum
 MTL = MeTal
 N = North
 NGT = Not Greater Than
 NLT = Not Less Than
 DA = OverAll
- DFL = Over Floor Leve
 DHD = OverHead Door
 DTL = OutLet
 PB = PanelBoard
 RCP = (electrical) Receptacle
 S = South
 TYP = TYPical
 U = Utility
 UDN = Unless Otherwise Noted
 W = West
 WDW = Window
 WL = WaLL

KEY TO SPACES:

- Vestibule
- Stoop
- G
- Pantry
- Bedroom
- Family Room
- CLD
- K
- DK

LEGEND:

- Peripherals: CL = Cable; SD = Smoke detector, CV = Central Vacuum; TP = Telephone (landline); DC = DR chime
- ⊕ LMR, default= CLG-mounted, may be pendant, surface-mounted, or recessed, P = protected from physical harm
- ⊙ Exhaust fan, CLG-mounted (to EXT, 150 CFM MIN)
- ⊕ RCP, duplex, 120V/20A only; G=GFCI; boxed
- T=tombstone, or pedestal, or monument type, ABS
- ⊕ Switch, default = SP WL-mounted, w/3=2-way, w/4=3-way, w/ M = Momentary
- ⊕ Motor

BIND LEFT

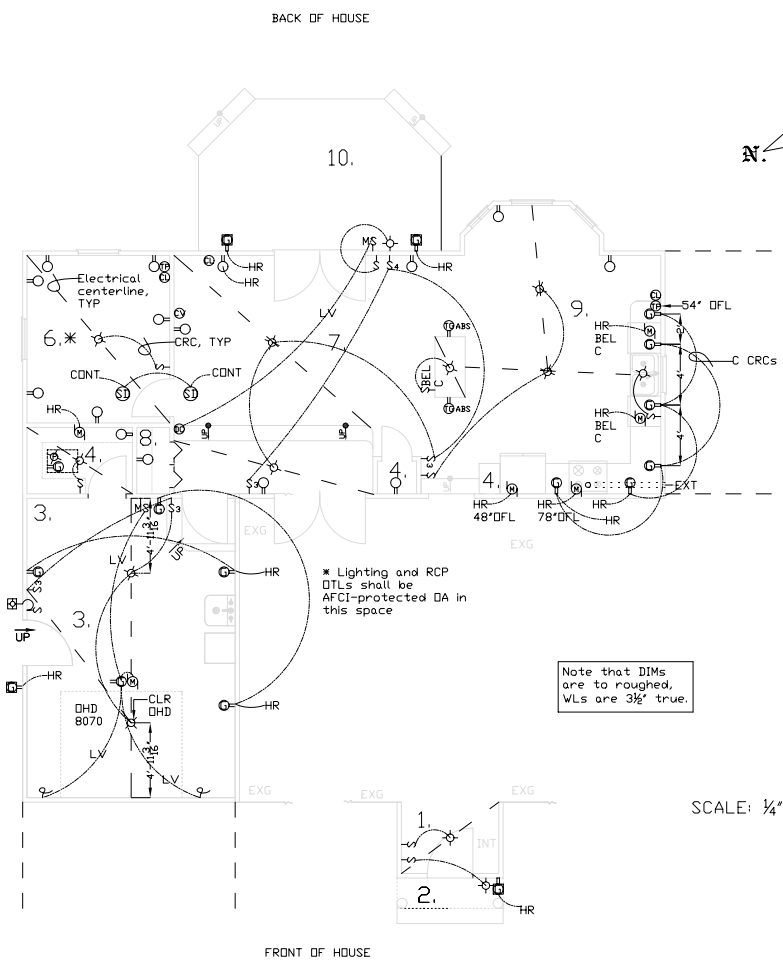

NOTE that this lighting layout is a MIN for safety and convenience, and may be augmented and resited as owners and lighting professionals see fit.

Note that DIMs are to roughed, WLS are 3/8\"/>

SCALE: 1/4\"/>

Copyright 2003 Before The Architect
<http://www.beforethearchitect.com>
 Errors & Omissions

DISCLAIMER: Before The Architect tried to do its best on this design plan based on knowledge, experience, statements, and instructions. However, others will provide on-site consulting, supervise and control construction, and no one on the planet can ever possibly know all the codes, requirements, means, materials, and other conditions involved in this project; therefore, there cannot be any warranty, express or implied, w/ respect to the content or use of this plan, including but not limited to any warranty of merchantability or fitness of construction, durability, function, safety, or hazards pre- or post-construction, or any liability for any errors or omissions due to incorrect information shown on this print. Use of this print is absolutely 100% at your own risk.